

REV.	DATE	ECO	DESCRIPTION	BY	CK	APP
C	4/21/2023	17351	ADDED CAT. NOS. MDC10M(70-200)BEI	ABT	N/A	SEE ECO
D	8/28/2023	17758	REMOVED MDC10(70-200)BEI	ABT	N/A	SEE ECO

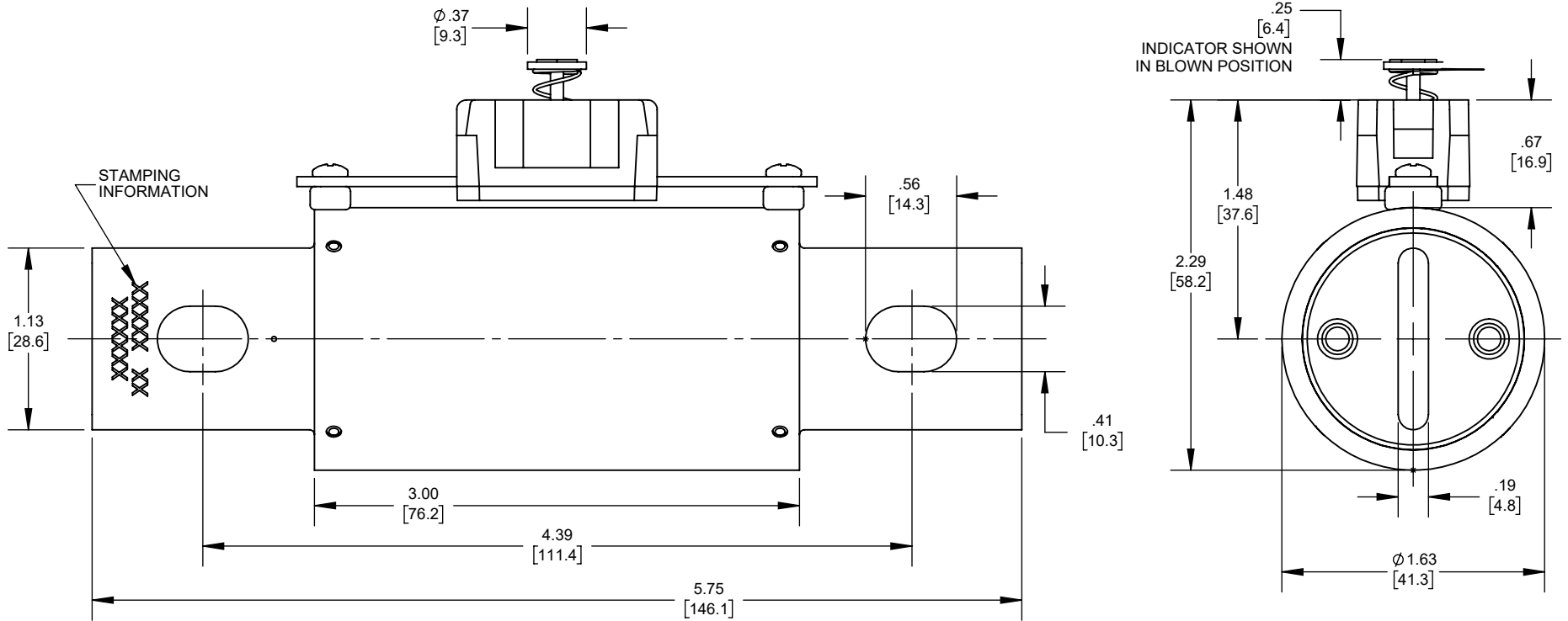

OUTLINE DIMENSIONS
NOT TO BE USED FOR PRODUCTION

DIMENSIONS IN []
ARE MILLIMETERS

Approval stage / Etat d'approbation: APPROUVÉ POUR FABRICATION / APPROVED FOR MANUFACTURING		Product Class:/ Product Type: CLASS J EI PHOTOVOLTAIC FUSE	
Initial ECO / ECO intiale: ECO-17351-000		Product amp rating:/ Voltage rating: 70 - 200A 1000VDC/600VAC	
Draw by / Dessiné par: Alma Balcazar	Date : 9/6/2023	Title / Titre: OUTLINE HP10J(70-200)EI	
Checked by / Vérifié par: Yadyra Fang	Date : 9/6/2023		
Electrical Power 374 MERRIMAC STREET NEWBURYPORT, MA 01950		Drawing / de dessin: 701865	
Éch / Scale : 1:1 Format / Size : A		Part / Article: SEE TABLE	Page : 1/1
MERSEN			

Weight :
Masse :

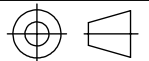

Rev : **D**
Rév :

HP10J200EI
HP10J160EI
HP10J125EI
HP10J100EI
HP10J80EI
HP10J70EI

CATALOG
NUMBER

Ce plan strictement confidentiel est la propriété exclusive de la société MERSEN sans l'autorisation écrite de laquelle il ne peut être ni reproduit, ni copié, ni communiqué à des tiers.
This drawing and specifications there on is property of MERSEN and shall not be reproduced or copied or used in whole or in part as the base for manufacture or sale of item without written permission.