

REV	DATE	ECO	DESCRIPTION	BY	CK	APP
A	5/21/08	N/A	REMOVED 81 CONN TYPE IN TABLE. SEPERATED LOAD AND LINE SIDE IN EXPLODED VIEW	LDB	N/A	N/A

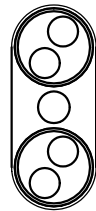

91

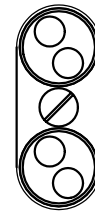
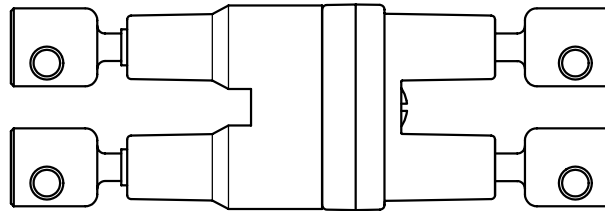

91

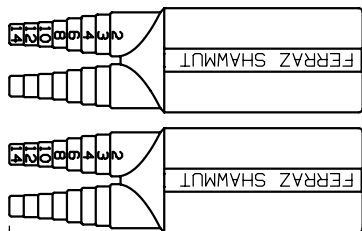

(FSB2 BOOT)

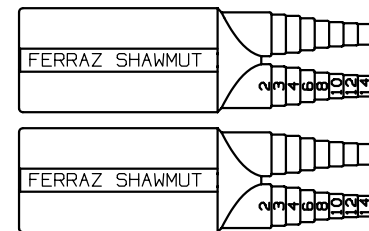
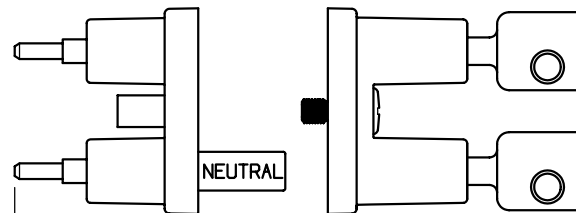
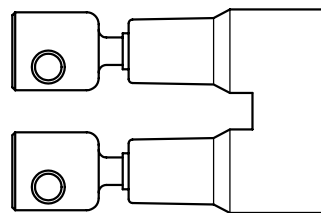

(FSB2 BOOT)

4.6" (116.2mm)

6.3" (160mm) ASSEMBLED LENGTH

8.7" (221mm) ASSEMBLED LENGTH

P/N	AMPERE RATING	RMS SYM RATING	CONN TYPE	TORQUE (LBS-IN)	WIRE			UL		CSA	
					WIRE RANGE	°C	TYPE	FILE NO.	GUIDE NO.	FILE NO.	CLASS
FEXN-91-91-BA	30	100,000	91-Cu DOUBLE SET SCREW	50 35 25 20	{1} #2-3 SOL/STR {1} #4-6 SOL/STR {1} #8 SOL/STR {1} #10-12 SOL/STR	75	Cu	E52283	IZLT2	32169	6225

Ferraz Shawmut
 FERRAZ SHAWMUT INC.
 374 MERRIMAC STREET
 NEWBURYPORT, MA 01950

PRODUCT MANAGER DESIGN ENGINEER

SIGN: SIGN:
 DATE: DATE:

FUSE HOLDER, 600V-30A,
 2 POLE, IN-LINE,
 MIDGET
 BREAKAWAY CONFIGURATION

OUTLINE DIMENSIONS
 NOT TO BE USED FOR PRODUCTION

701372